

Dixon Street, Pontefract

£825 Per Calendar Month

2

1

1

71

This beautifully presented property is ideal for couples, small families, or professionals looking for a stylish and conveniently located home.

Situated close to local schools, amenities and transport links, the property offers comfortable living in a quiet residential area.

Finished to a high standard throughout, the home features a spacious and contemporary kitchen diner, perfect for both everyday living and entertaining, along with a modern bathroom suite and two first-floor bedrooms.

Tastefully decorated with a fresh and neutral finish, this attractive property provides a welcoming and move-in-ready home.



- Great Location - Close to Local Schools
- Spacious Lounge
- Modern Kitchen Diner
- Two First Floor Bedrooms
- Stylish Family Bathroom
- Private Rear Garden
- On-Street Parking
- EPC Grade C
- Council Tax Band A

Call **01977 285 111** to view this property or visit www.crownestateagents.com

Opening hours:
 Mon - Fri 9am - 5pm
 Sat 10am - 2pm

Lounge

12'6" x 11'9" (3.82 x 3.59)

A well-proportioned room featuring a window to the front elevation, allowing for plenty of natural light. Finished with a modern grey carpet and complemented by coved ceiling detailing, the space also benefits from a central radiator, creating a comfortable and inviting feel throughout.

Kitchen Diner

13'0" x 12'6" (3.98 x 3.82)

A stylish and well-presented kitchen diner featuring modern grey worktops and a range of fitted units with under-cupboard lighting, creating a sleek and contemporary feel. The space benefits from a built-in oven, electric hob, and single sink with drainer, alongside a practical breakfast bar ideal for casual dining. A window to the rear elevation provides natural light, with convenient access to the rear garden completing this highly functional and inviting space.

Bedroom 1

11'9" x 12'6" (3.59 x 3.82)

A clean and well-presented bedroom offering a bright and comfortable living space. Finished with modern grey carpeting, the room is complemented by a front-facing window that allows for plenty of natural light and an open feel.

Bedroom 2

6'8" x 13'0" (2.04 x 3.98)

A compact and neatly presented room, ideal as a home office or additional bedroom, featuring a rear-facing window to the garden. The space is finished in a simple, clean style, offering a versatile and practical layout throughout.

Family Bathroom

9'10" x 5'10" (3 x 1.78)

A well-presented bathroom finished with warm beige tiling and a contrasting dark mosaic feature wall. The space includes a curved bathtub with glass shower screen and a practical vanity unit with a large round mirror above. A frosted uPVC window provides natural light while maintaining privacy, contributing to a clean and bright feel throughout.

Rear Garden



Floor Plan

GROUND FLOOR
328 sq ft. (30.5 sq.m.) approx.

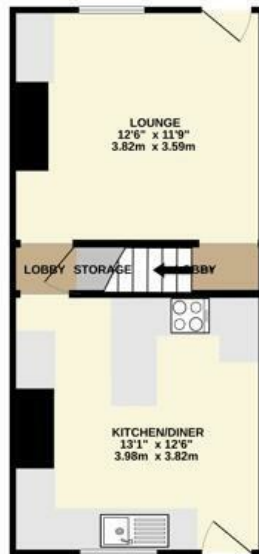

1ST FLOOR
328 sq ft. (30.4 sq.m.) approx.

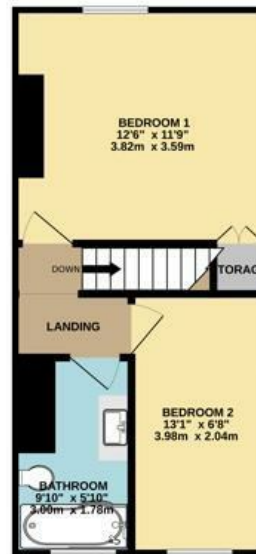

TOTAL FLOOR AREA: 655 sq ft. (60.9 sq.m.) approx.
While every effort has been made to ensure the accuracy of the floorplan, Crown Estate Agents, its agents and any other third parties are not responsible for any errors, omissions or misstatements. This plan is for guidance purposes only and should not be used as a basis for any prospective purchase. The person, systems and apparatus shown have not been tested and no guarantee is given as to their operation or efficiency and no guarantee is given as to their accuracy. Made with Metropix 10/25



Energy Efficiency Rating

	Current	Potential
Very energy efficient - lower running costs		
(92 plus) A		
(81-91) B		
(69-80) C	71	
(55-68) D		
(39-54) E		
(21-38) F		
(1-20) G		
Not energy efficient - higher running costs		
England & Wales	EU Directive 2002/91/EC	

Please call our Crown Estate Agents Office on 01977 600633 if you wish to arrange a viewing appointment for this property or if you require further information.

These particulars, whilst believed to be accurate are set out as a general outline only for guidance and do not constitute any part of an offer or contract. Intending purchasers should not rely on them as statements of representation of fact, but must satisfy themselves by inspection or otherwise as to their accuracy. No person in this firm's employment has the authority to make or give any representation or warranty in respect of the property.

Call 01977 285 111 to view this property or visit www.crownestateagents.com

Opening hours:
 Mon - Fri 9am - 5pm
 Sat 10am - 2pm